

**Model No.:** R 10 11 12 S R2 0C-2P

**Description:** Rotary Cam Switch 10A, 2pole, 2Way with 1 NO+1NC



### Salient Features:

- Quick installation
- Safe operation
- Robust design
- Wide application e.g. elevator industries, motor control, automation, machineries etc

### General Characteristics:

It's a cam operated control switch with wide application in electrical, electronics & instrumentation equipments. It is available with minimum one & maximum twelve packets. It is used to perform Make and Break operation in a sequential way by rotating the switch to different positions. The Cam, which closes and opens the contacts, has rotary movement to multiple positions, thereby multiple Circuit functions can be controlled. Further, the flexibility in the switch type selection covering various current /voltage ratings and options to select the number of contacts, is added advantage. This ensures that a right switch is chosen for the desired application. Rotary Cam Switches thus offer complete design flexibility to assemble complex switching programs, contact ratings and customize all switching applications. It is suitable for AC as well as DC switching applications.

Available types	: Available in momentary, stay put & combination of momentary & stay put. Codes available on request
Degree of protection	: IP65 as per IEC 60529
Degree of Pollution	: 3
Applicable standards	IEC 60947-3 IEC 60204-1
Product Certification	Pending

### Mechanical Characteristics:

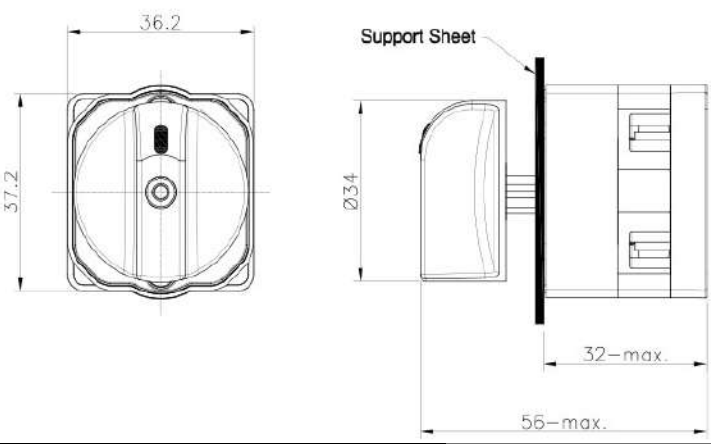
Function indicator		: Arrow indication on the knob
Terminal Capacity		: Maximum 2 X 0.75mm <sup>2</sup> : Minimum 1 X 0.5 mm <sup>2</sup>
Terminal marking		: 1 2 (NC) 3 4 (NO)
Terminal Torque	Nm	: 0.8
Contact material		: Brass, Silver plated (for regular applications) : Brass, Gold plated (for Low voltage/Low Current infrequent applications)
Operation		: Slow break (NO/NC)
Operating torque	Nm	: 11
Operating force	N	: NA
Positive operation Conforming to IEC/EN 60947-5-1 Appendix K		: All functions incorporating a NC contact are positive opening operation
Operating travel	mm	: NA
Mechanical life		: 2,00,000 operations
Ambient	°C	: -25 to +70
Storage	°C	: -25 to +40
Overall Dimensions with sketch (LXBXH)	mm	: 
Vibration resistance Conforming to IEC 60068-2-6	Hz	: Pending
Shock resistance Conforming to IEC 60068-2-27		: Pending
Viewing Angle	°	NA
Optical Axial intensity	mcd	NA
Weight	gms	80

### Electrical Characteristics of contacts:

Make & Break Capacity		: Utilization Category : AC1/AC21: 10A : AC23/AC3: 2Kw : AC11: Single phase motor at 220V, 4A Three phase motor at 440V, 3A
Rated insulation voltage	V	: 600
Rated thermal current	A	: 10
Low power application		: Gold plated NO & NC contact elements for low voltage/low current switching circuits infrequent applications (<25mA)
Short circuit protection		: NA
Dielectric Test	KV	: 2.5
Approvals regarding the part:		: Pending
Approvals regarding the material		
Polymeric parts		: UL-Recognized material
Rated Impulse Withstand		: NA
Polarity protection		: NA
Current Consumption	mA	: NA
Electrical Endurance		: at rated current over 50000 operations

### Accessories & codes:

NA

#### Ordering codes

The ordering code for each product is mentioned in the Catalogue/Data Sheet and not indicated on each product because of the various combinations possible it becomes practically impossible to do so. However the primary packing box always mentions the ordering code of the material it holds.

<b>R</b>	<b>10</b>	<b>11</b>	<b>12</b>	<b>S</b>	<b>R</b>	<b>2</b>	<b>0</b>	<b>C</b>	<b>-2P</b>
↓	↓	↓	↓	↓	↓	↓	↓	↓	↓
<b>Rotary Switch</b>	<b>Rating in Amperes</b>	<b>Number of NO &amp; NC contact 1 letter is NO second letter is NC</b>	<b>Starting position with respect to Clock</b>	<b>S=Stopper C=Continuous rotation</b>	<b>R=Regular E=Extended</b>	<b>Color of knob 2=Black</b>	<b>0=No flange 1=With flange</b>	<b>C= cover mounting B= Base mounting D=DIN mounting</b>	<b>2 position stayput</b>

### Mounting Instructions:

Safety regulations: This unit may be installed & commissioned by personnel who are familiar with current regulation for health & safety at work & accident prevention. Ensure local regulations are met especially those relating to safety. Ensure that this Rotary Cam switch will operate fully after installation. Failure to follow these will result in death or serious injury.

#### Mounting

: Fixing Centers: 30mm X 25mm Min.  
Mounting Panel thickness: 1mm to 3mm

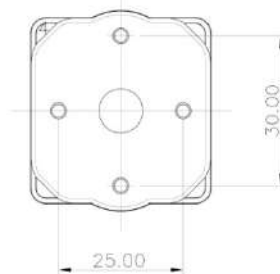

Switch Mounting Details

4 holes - for self threading screw - M3x9 mm

12 packets max

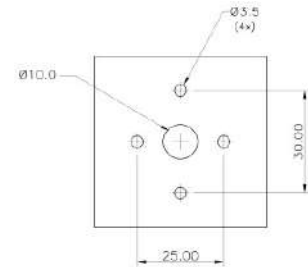

Drilling Plan  
for Panel Mounting

No of elements possible

### To install:

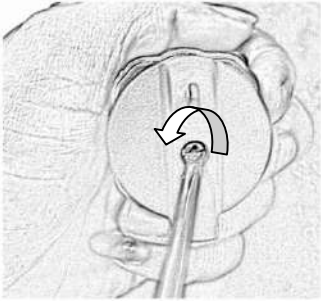

Remove the screw on the knob by turning in anticlockwise direction

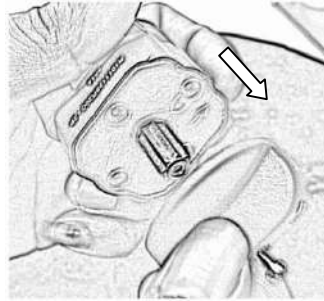

Remove the knob by pulling it up

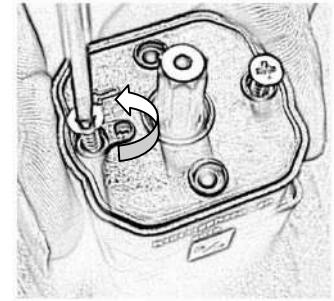

Remove both panel fixing screws on the Rotary Switch

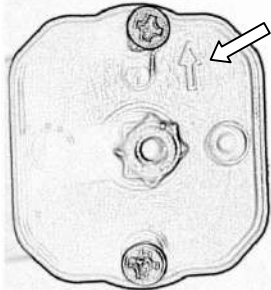

Align the arrow on the top position on the panel

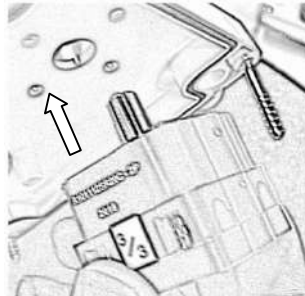

Insert the Rotary Switch in the panel cutout from the rear side



Insert both panel fixing screws from top of the panel from the front side

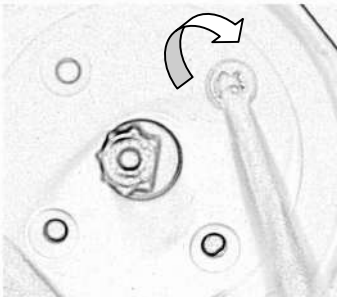

Tighten the screw with a torque of 0.5Nm

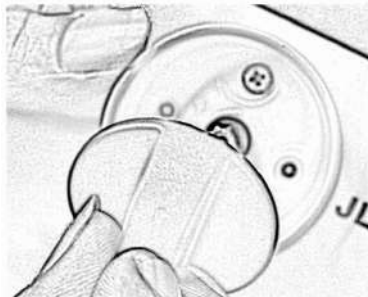

Insert the knob back to the Rotary Switch



Tighten the screw of the knob with a torque of 0.5Nm. Rotate & check the operation of the switch

### To uninstall:

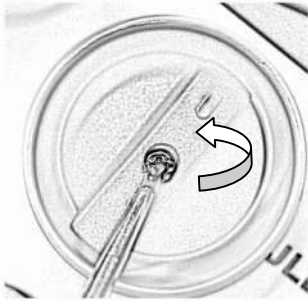

Turn the screw in anticlockwise direction

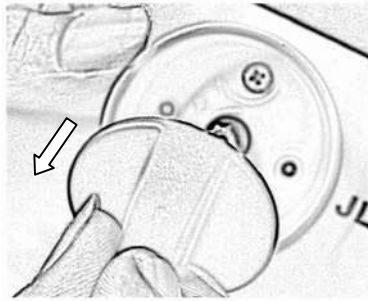

Remove the knob

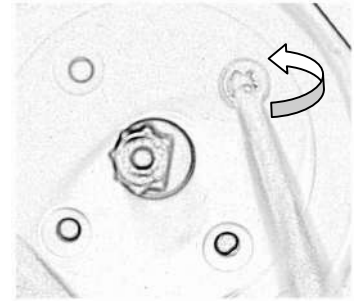

Unscrew both panel mounting screws by turning them in anticlockwise direction

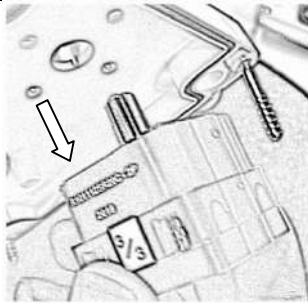

Remove the switch

If any more information is required, kindly contact our Marketing Department at +91-22-42532500 or email at [ram.talreja@teknico.in](mailto:ram.talreja@teknico.in)